

LTE22S-T1F1 AC/DC Switching Power Supplies

22W SINGLE OUTPUT

INPUT SPECIFICATIONS :

VOLTAGE	90-264 VAC, UNIVERSAL
FREQUENCY	AUTO RANGING
CURRENT	0.7 ARMS. MAX. @115VAC 22W LOAD
	0.35 ARMS. MAX. @230VAC 22W LOAD
INRUSH SURGE CURRENT	< 30AP-P TYPICAL, COLD START @25°C, 115VAC

OUTPUT SPECIFICATIONS :

OUTPUT WATTAGE	22 WATTS MAX. (CONVECTION RATING)
LINE REGULATION	+/-1.0% TYPICAL
LOAD REGULATION	MAIN OUTPUTS +/- 2%, AUX. OUTPUTS +/- 10% TYPICAL (NOTE2)
NOISE & RIPPLE	1% TYPICAL AT FULL LOAD (NOTE3)
OVERSHOOT/UNDERSHOOT	±10% MAX. @ TURN-ON/ TURN-OFF

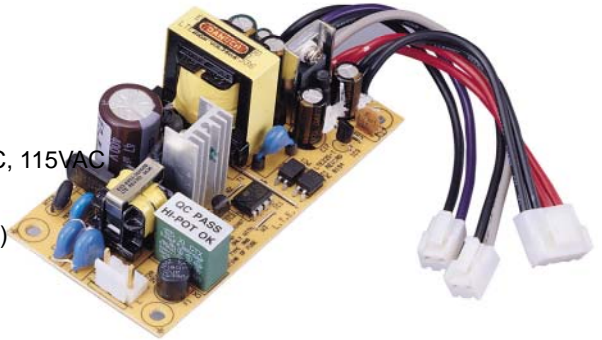

VOLTAGE (Vdc)	LOAD RANGE (A)			LINE REGULATION	LOAD REGULATION (NOTE 2)	RIPPLE & NOISE (NOTE 3)	
	MIN	MAX	PEAK (N1)				
V1	+5V	0.2A	2.0A	2.3A	±1.0%	4.9~5.1Vdc (±2%)	50mVp-p (1%)
V2	-48V	0.01A	0.25A	0.3A		-43.2~-52.8Vdc (±10%)	480mVp-p (1%)
V3	-65V	0.01A	0.185A	0.2A		-58.5~-71.5Vdc (±10%)	650mVp-p (1%)

- Note :** 1. Peak current lasting <30 seconds with a maximum 10% Duty Cycle.
 2. Cross/Load regulation is tested at 10% to 100% of rated load and other outputs are set at 50% of rated load.
 3. Peak-to-peak for 22W (convection rating) @100Vac MIN. ; Measurements with a 20MHZ bandwidth and terminated with a 10uF electrolytic CAP. in parallel with a 0.1uF ceramic Cap.

ENVIRONMENTAL :

OPERATING TEMPERATURE : 0°C TO 40°C AMBIENT, DERATED EACH OUTPUT AT 2.5% PER °C FROM 50°C TO 70°C
 STORAGE TEMPERATURE : -40°C TO 85°C
 HUMIDITY : OPERATING, NON-CONDENSING, 5% TO 95%
 VIBRATION : RANDOM OPERATING 2.4 GRMS/MAX. 3 AXES 50~500Hz 10 MINUTES/AXIS
 SHOCK : OPERATING HALF SINE 20 GPK/MAX. 3 AXES 10ms 6 SHOCKS TOTAL

GENERAL SPECIFICATIONS :

EFFICIENCY : @115VAC WITH FULL LOAD >77% AND @230VAC WITH FULL LOAD >77%
 TURN-ON TIME : @115 VAC WITH FULL LOAD < 3 SEC
 HOLD-UP TIME : @115VAC WITH CONVECTION RATING >16MSEC

ELECTROMAGNETIC COMPATIBILITY SPECIFICATIONS :

EMI CONDUCTED/RADIATED : FCC PART15 & CISPR 22 & EN55022 CLASS B
 DESIGNED TO MEET EN61000-3-3,-4-2,-3,-4,-5,-6,-11
 DESIGNED TO MEET THE FOLLOWING STANDARDS UL 60950, CUL 60950, TUV EN60950, CB, CE MARKED

Connector Types & Pin Assignments

Connector Number	Connector Type	Pin Number	Signal
J1 (Input)	JST#B 2P-VH-3 or Equivalent (Gold plate)	Pin1 Pin2	N L
J2 (Output)	JST#VHR-2N or Equivalent (Gold plate)	PURPLE BLACK	-48V RETURN
	JST#VHR-2N or Equivalent (Gold plate)	GRAY BLACK	-65V RETURN
	JST#VHR-4N or Equivalent (Gold plate)	RED BLACK	+5.0V RETURN

MECHANICAL SPECIFICATION

I/O CONNECTORS : SEE TABLE

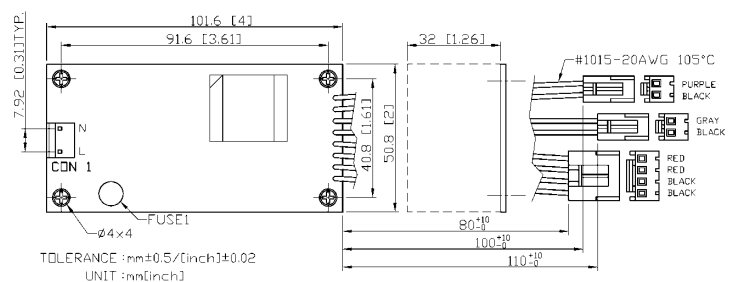

SAFETY STANDARD & QUALITY APPROVALS :



TBD.



TBD.



TBD.



Q5954